

DO NOT SCALE

100
10
0
Millimetres

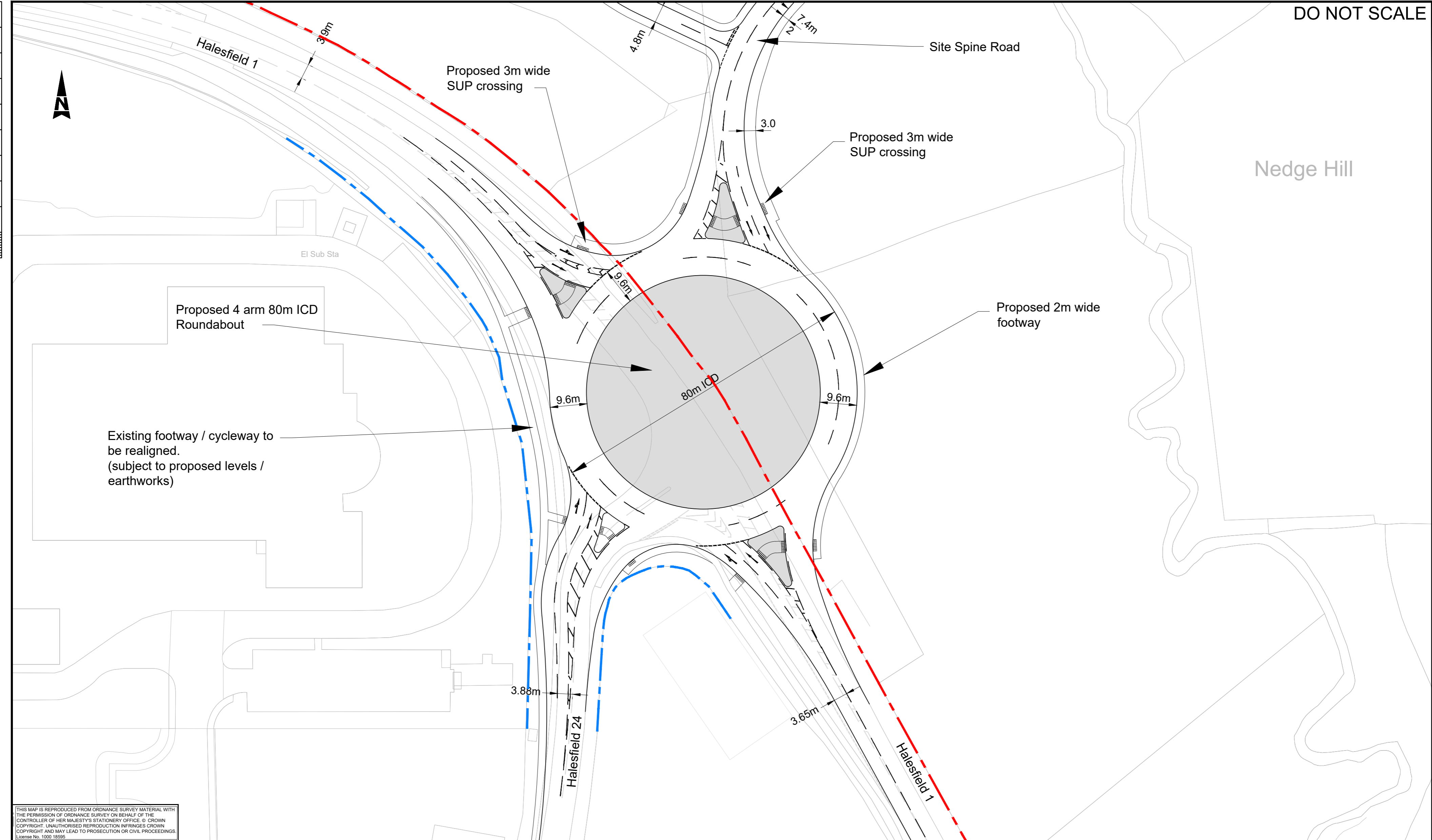

THIS MAP IS REPRODUCED FROM ORDNANCE SURVEY MATERIAL WITH THE PERMISSION OF ORDNANCE SURVEY ON BEHALF OF THE CONTROLLER OF HER MAJESTY'S STATIONERY OFFICE. © CROWN COPYRIGHT. UNAUTHORISED REPRODUCTION INFRINGES CROWN COPYRIGHT AND MAY LEAD TO PROSECUTION OR CIVIL PROCEEDINGS. License No. 1000 18595

Key:

- Site Boundary
- Assumed Highway Boundary
- Proposed Traffic Islands
- Possible Earthworks (shown indicatively)
- ||||| New Tactile Paving

Notes:

- Layout is preliminary design 'for information' only. Based on Ordnance Survey data.

SAFETY, HEALTH AND ENVIRONMENTAL INFORMATION	
In addition to the hazards/risks normally associated with the types of work detailed on this drawing, note the following:	
CONSTRUCTION	
Live traffic Live utilities, Presence of soil contamination, asbestos, Hazardous tar and breaking of concrete not known	
MAINTENANCE/CLEANING	
NONE	
DECOMMISSIONING/DEMOLITION	
NONE	

Rev.	Date	Description	By	Chkd	App'd
P2	12.03.21	HALESFIELD 24 APPROACH ALIGNMENT MODIFIED	AE	PDE	
P1	14.05.20	DRAFT DESIGN FOR REVIEW	AE	PDE	

ATKINS

The Axis
10 Holiday Street
Birmingham
West Midlands
B1 1TF

Tel: +44 (0)1214 835000
Fax: +44 (0)1214 835252
www.atkinsglobal.com

Copyright © Atkins Limited (2020)

Project Title THE HEM, NEDGE HILL, TELFORD				
Drawing Title PROPOSED 4 ARM ROUNDABOUT GENERAL ARRANGEMENT OPTION 1				
Scale 1:500	Designed AE	Drawn AE	Checked PDE	Authorised
Original Size A2	Date 14.10.20	Date 14.10.20	Date 14.10.20	Date
Drawing Number HA PIN HEM	Originator - ATK	Volume - HGN	Project Ref. No. 5165616	
Location HALES	Type -DR	Role - D	Number - 002	Revision P2